

Fill Cluster

Type 07018 - Fill cluster with check function



Cryogenic-Fill cluster, PN50

Stainless steel body and bronze topwork
with check function and drain valve
"live loaded" gland packing
"cleaned and degreased for oxygen service"

Part No. 07018.X.***

Fill connection: Mueller flange
Outlet: welded stainless steel stubs acc. to ASTM A312
Non-return unit metal to metal seated, leakage rate D acc. to EN12266-1

Available options - on request only:

- with strainer

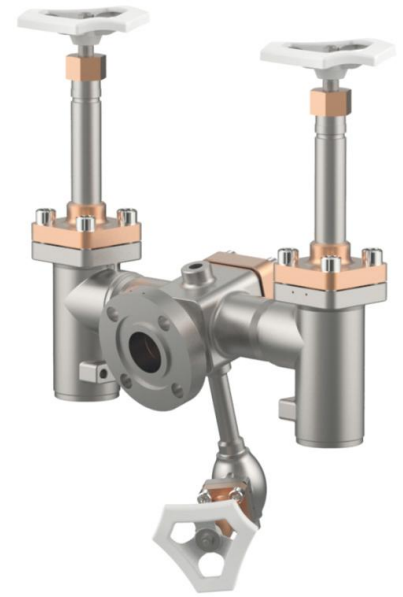

Applications:

Approved for air gases, vapours and cryogenic liquefied gases incl. LNG.
Working temperature: -196°C / -321°F (77K) up to +120°C / +248°F (393K)

| Materials | DIN EN | ASTM |
|-------------------|----------------------------|------------------|
| 1 Fill body | 1.4308 | A 351 CF8 |
| 2 Body | 1.4308 | A 351 CF8 |
| 3 Valve seal | PTFE / Carbon filled (25%) | |
| 4 Disc | CW614N | B 283 UNS C38500 |
| 5 Bonnet gasket | PTFE | |
| 6 Headpiece | CC493K | B 505 UNS C93200 |
| 7 Bolts | 1.4301/A2 | A 194 B8 |
| 8 Elongation tube | 1.4541 | A 213 TP 321 |
| 9 Stem | 1.4301 | A 276 Grade 304 |
| 10 Gland packing | Graphite / PTFE | |
| 11 Gland nut | CC493K | B 505 UNS C93200 |
| 12 Handwheel | Aluminium alloy | |

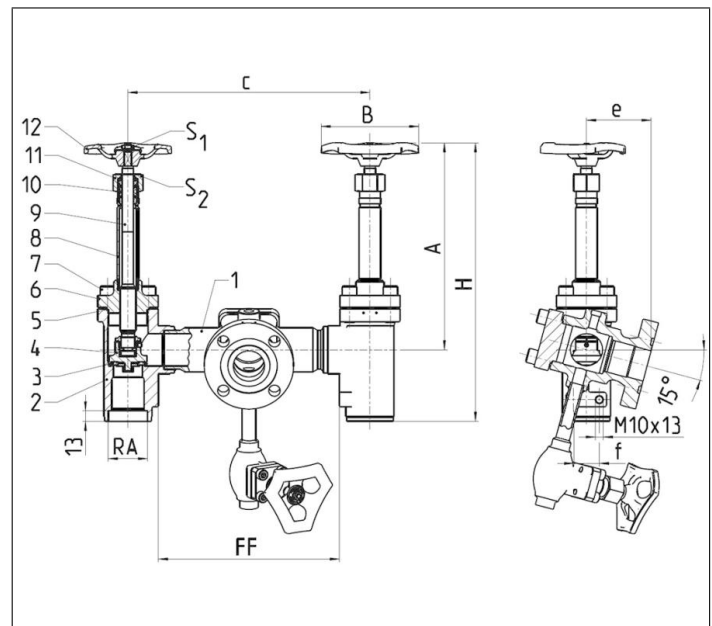

| Type 07018 - Standard design | Technical data | | | |
|-------------------------------|----------------|-------------------------------|------|------|
| Nominal size | DN | 25 | 40 | 40 |
| Dimension code | .X. | 2533 | 4045 | 4048 |
| Face-to-face dimension | FF | 225 | 225 | 225 |
| Outside pipe-Ø ASTM A312 | RA | 33.7 | 45.4 | 48.3 |
| Wall thickness pipe ASTM A312 | a | dimensions acc. to S10 or S40 | | |
| Socket depth | b | 13 | 13 | 13 |
| Height | A | 270 | 270 | 270 |
| Height | H | 735 | 735 | 735 |
| Length | c | 295 | 301 | 301 |
| Length | e | 82 | 82 | 82 |
| Length | f | 32 | 32 | 32 |
| Handwheel-Ø | B | 100 | 125 | 125 |
| Wrench size across flats | S ₁ | 10 | 13 | 13 |
| Wrench size across flats | S ₂ | 27 | 32 | 32 |
| Weight | ca. kg | 11.5 | 14.9 | 14.9 |

Dimensions in mm.